

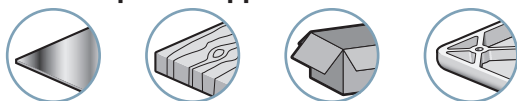

Branch-specific applications



Presentation

The profile of the VPG series extra-flat suction pads provides for accuracy in load gripping and speeds up throughput rates. These suction pads are used for flat surfaces only.

2

Types of use



Materials

NBR Nitrile
SI Silicone

STN Siton®
PUB Blue polyurethane

SIA Antistatic silicone
FPM Viton

	Ø (mm)	Volume (cm³)	Force (N) (1)	Force (N) (1)	R _{min} (mm)	NBR	SI	STN	PUB	SIA	FPM
VPG 1	1	0.00015	0.03	0.015	2	■	■	□	□		
VPG 1.5	1.5	0.00053	0.06	0.03	2	■	■	□	□		
VPG 2	2	0.00073	0.11	0.06	2	■	■	■	■	■	
VPG 3.5	3.5	0.0022	0.34	0.17	8	■	■	■	■	■	■
VPG 5	5	0.005	0.67	0.34	8	■	■	■	■	■	
VPG 6	6	0.008	0.98	0.49	8	■	■	■	■	■	
VPG 8	8	0.03	1.7	0.85	10	■	■	■	■	■	■
VPG 10	10	0.07	2.8	1.40	13	■	■	■	■	■	■
VPG 15	15	0.2	6.5	3.3	13	■	■	■	■	■	■
VPG 15A	15	0.2	6.5	3.3	13	■	■	■	■	□	□
VPG 20	20	0.5	12.2	6.1	20	■	■	■	■	■	■
VPG 20B	20	0.5	12.3	6.5	20	■	■	■	■	□	□
VPG 25	25	1.1	16.7	8.4	25	■	■	■	■	■	
VPG 30	30	1.4	22.7	11.4	40	■	■	■	■		■
VPG 35	35	2.9	33	16.5	50	■	■	■	■		
VPG 40	40	3.8	48	24	50	■	■	■	■		■
VPG 50	50	5.3	75	37.5	75	■	■	■	■		■
VPG 60	60	12	123	61.5	100	■	■	■	■		■
VPG 60S	60	12	123	61.5	100	■	■	■	■		■
VPG 80	80	26.9	198	99	150	■	■	■	■		■
VPG 80S	80	26.9	198	99	150	■	■	■	■		■
VPG 95	95	41	280	140	200	■	■	■	■		■
VPG 95S	95	41	280	140	200	■	■	■	■		■
VPG 120	120	141	365	182.5	365	■	■	■	■		
VPG 150	150	230	590	295	380	■	■	■	■		
VPG 200	200	384	1050	525	430	■	■	■	■		

(1) Actual force of the suction pad in use with a 90% vacuum and including a safety factor of 2 for horizontal handling and a factor of 4 for vertical handling.

■ Standard / □ On request

Choice of fittings

		M3 M	M5 M	M5 F	M6 M	M8 M	M10 M	M10 125 pitch	1/8 F	1/8 M	1/4 F	1/4 M	1/2 F
1, 1.5	2/18	■											
2, 3.5	2/18	■	■										
15A, 5... 10	2/18		■	■					■	■			
15, 20	2/19		■						■	■			
20B, 25... 50	2/20				■	■	■		■	■	■	■	
60... 95	2/21							■			■	■	
60S... 95S	2/21										■		
120... 200	2/21												■

■ Standard Fitting: M = male F = female

For all orders, please specify:

Model + Diameter + Material

E.g. **VPG 50 FPM** (VPG series, Diameter 50, in Viton)

1: Model

VPG

2: Diameter

1 ... 200

3: Material

NBR See table

Dimensions

VPG 1 - 1.5

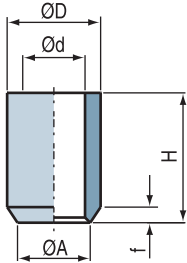

VPG 15A, VPG 2... 10

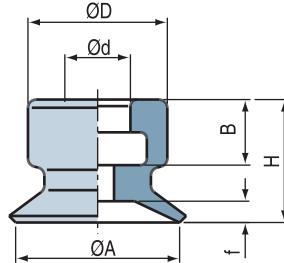

VPG 20B, VPG 15... 50

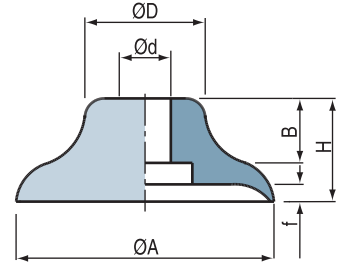

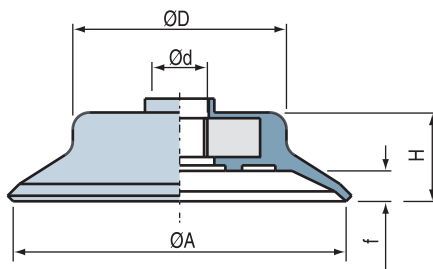

VPG 60 - 95

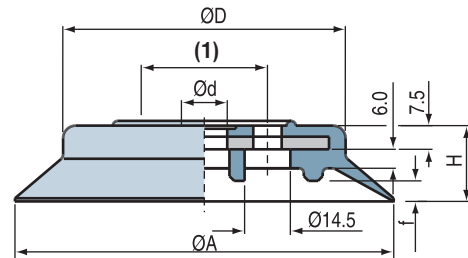

VPG 120... 200



(1) 4 holes
Ø9 on Ø40

	Ø A (mm)	H (mm)	Ø d (mm)	Ø D (mm)	f ⁽¹⁾ (mm)	B (mm)	 (g)
VPG 1	1	1.6	0.8	1.2	0.2	-	
VPG 1.5	1.5	2.5	1.2	1.8	0.3	-	
VPG 2	2	4	2	4	0.5	2.5	
VPG 3.5	3.5	4	2	4	0.5	2.5	
VPG 5	5	6.5	4	7.5	0.8	4	
VPG 6	6	6.5	4	7.5	0.8	4	
VPG 8	8	7	4	8	1.2	4	0.26
VPG 10	10	7.5	4	8.7	1.5	4	0.36
VPG 15	15	8	4.5	12	1.9	2.5	0.9
VPG 15A	15	8	4	9	1.9	4	0.9
VPG 20	20	10	4.5	15	2.3	4.5	1.93
VPG 20B	20	10	6	15	2.3	7	2.5
VPG 25	25	14	6	16	3	7	3
VPG 30	30	12	6	15	2	7	4
VPG 35	35	14	6	20.5	3	7	6.8
VPG 40	40	14	6	23.5	3.5	7	8.4
VPG 50	50	15	8	29	4	7	13
VPG 60	60	16	M10x125	38	5	-	25
VPG 60S	60	16	1/4G	38	5	-	25
VPG 80	80	18	M10x125	53	6	-	55
VPG 80S	80	18	1/4G	53	6	-	55
VPG 95	95	19	M10x125	68	6	-	96
VPG 95S	95	19	1/4G	68	6	-	96
VPG 120	120	24.5	14.5	89.5	6	-	242
VPG 150	150	30.5	13	105	9	-	480
VPG 200	200	35.5	13	143	12.5	-	840

The values represent the average characteristics of our products.

(1) f = Deflection of the suction pad.

Assembly diagrams

COVAL suction pads can be assembled in a wide variety of configurations.

see pages 2/18 to 2/21.

Accessories

To optimize use of your suction pads, Coval offers a comprehensive range of accessories (feelers, spring extensions, and feeder systems, etc.) see chapters 5 and 13.